

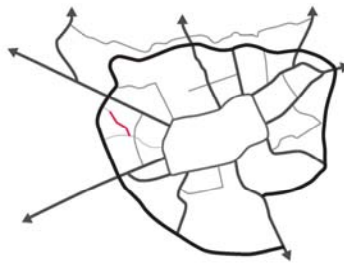

ZONING



INFRASTRUCTURE



BETWEEN 2 PARKS

The sites extraordinary assets are the location between two potential parks. The basic concept is to place a built structure that is permeable towards both.



KONFETTI

In order to balance the dominance of the residential towers in the north and profit from the parks also within the buildings, an airy distribution of high points is desired.



BIG ROCKS

The main access road folds through the area, being diverted by large urban 'rocks' that house commercial and public program.



ALTERNATING SCAPES

The space between the buildings is an alternation of access roads and semi-private courtyards. These courtyards allow for pedestrian traffic from and to the parks.

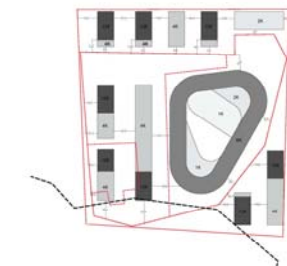

DISTANCES

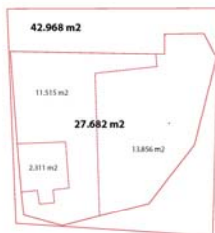

SQM

PARK CITY

Investor:

MANE TCI sh.p.k.
Autostrada Tirane - Durres,
Km 6, Kashar
Tel. +355 42 380 124

Architect:

cityförcster
rotterdam

Schiedamsse Dijk 4B
NL 3011 ED Rotterdam
fon: +31 (0) 10 41 777 94
fax: +31 (0) 10 41 777 95
www.cityfoerster.de
rotterdam@cityfoerster.de

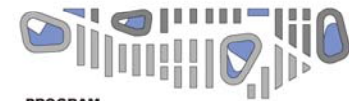

PROGRAM

The built structure is in principle programmatically neutral, except for the large groundfloors of the urban rocks. The representative design of the promenade makes it a premier location for offices.

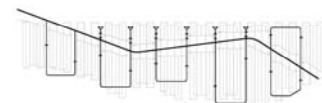

CIRCULATION

From the main road (connecting to the tertiary network), one-way loops access the strips, with alternating entry and exit to the parking to reduce car-traffic.

CROSS SECTION

